

MODEL
CSZN

Insert style, single ball shuttle valve with signal at port 2
CAPACITY: 4 L/min. | CAVITY: T-382A

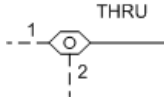

CONFIGURATION

X	Control	Not Adjustable
X	Adjustment Range	-
N	Seal Material	Buna-N

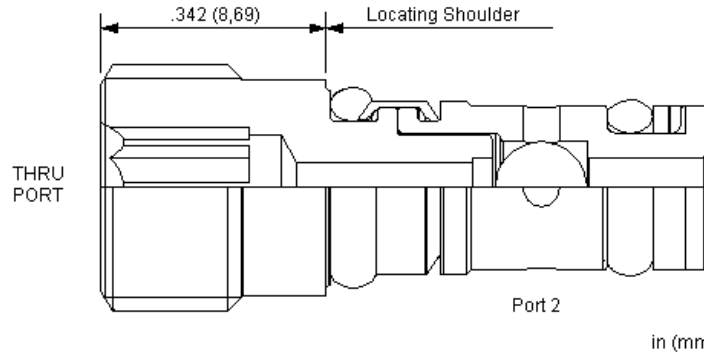

in (mm)



The single ball shuttle connects the higher of two work ports to the signal or common port. The signal is sensed at port 2.

TECHNICAL DATA

Cavity	T-382A
Series	Z
Capacity	4 L/min.
Maximum Operating Pressure	350 bar
Maximum Valve Leakage at 110 SUS (24 cSt)	0,3 cc/min.
Valve Internal Hex Size	4 mm
Valve Installation Torque	11 - 14 Nm
Seal kit - Cartridge	Buna: 990-382-007
Seal kit - Cartridge	Viton: 990-382-006
Model Weight	0.01 kg.

TECHNICAL FEATURES

- This valve is what we call an Insert style. It is meant to be buried in a manifold or actuator. The cavity drawing for the T-382A cavity contains a lot of detailed information and should be studied closely when applying this valve.
- Shuttle cartridges feature hardened steel balls and seats for excellent wear characteristics and contamination tolerance.
- The single ball allows for the decay of the pressure signal when both load ports drop to a lower pressure.
- Incorporates the Sun floating style construction to minimize the possibility of internal parts binding due to excessive installation torque and/or cavity/cartridge machining variations.

PERFORMANCE CURVES

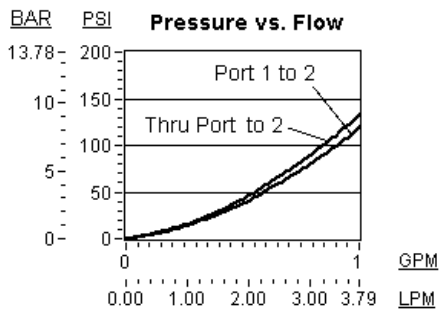

CONFIGURATION OPTIONS

CONTROL

Standard Options	X	Not Adjustable
------------------	---	----------------

ADJUSTMENT RANGE

Standard Options	X	-
------------------	---	---

SEAL MATERIAL

Standard Options	N	Buna-N
	V	Viton

Copyright © 2002-2014 Sun Hydraulics Corporation. All rights reserved.